



# Instructions for Ceramic Disc Cartridge for American Standard®

**Tools Needed:** Allen Wrench, Phillips Screwdriver, Silicone Grease (optional)

**Product may be used in a variety of faucet styles. Identify the illustration that looks most like your faucet to refer to during installation process.**

**Lavatory Faucet**

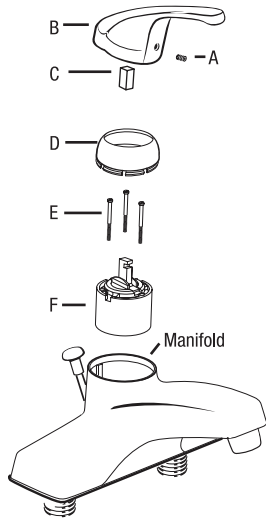

**Kitchen Faucet 1**

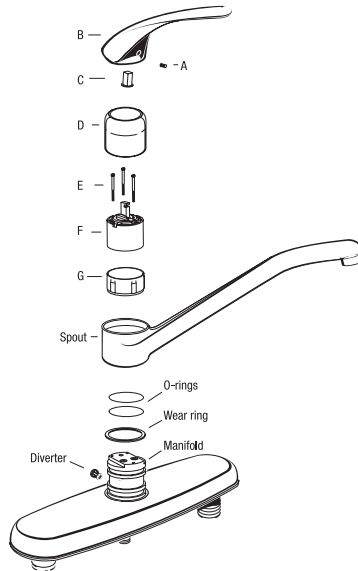

**Kitchen Faucet 2**

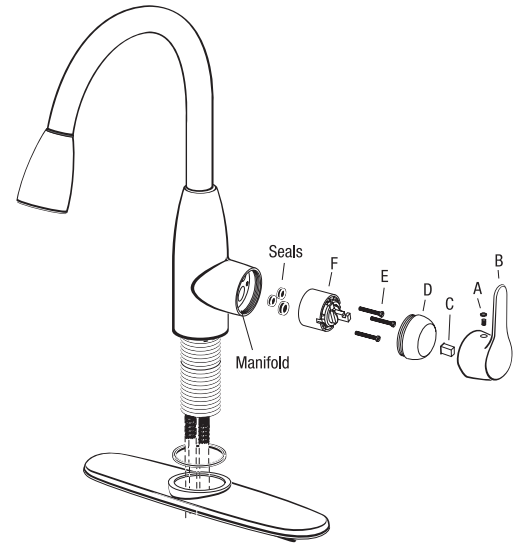

## Instructions:

1. Turn off water supply to faucet.
2. Remove Set Screw (A), Handle (B) and Handle Adapter (C).
3. Remove Cap (D) by turning counterclockwise.
4. Remove Cartridge Mounting Screws (E) and old Cartridge (F).
5. Clean the Manifold of any corrosion and debris.

**NOTE: If your style is similar to Kitchen Faucet 1, it is suggested that the Spout be lifted off and the Manifold and O-rings be lubricated with Silicone Grease to prolong the life of cartridge.**

6. Insert new Cartridge into Manifold and secure with Mounting Screws (E). DO NOT OVERTIGHTEN.
7. Turning clockwise, hand-tighten Cap (D) onto Manifold. Place Handle Adapter (C) onto cartridge stem. Place Handle (B) onto Handle Adapter (C) and secure with Set Screw (A).
8. Turn on water supply to faucet.
9. Test by turning on water and inspect for leaks.