



CARTRIDGE for Delta®

Compares to Delta® Diamond Seal™ Technology - RP50587

Visit
DANCO.COM
for Easy D.I.Y.
Solutions

Instructions: (Shut Off Water Supply)

Tools Required: Allen Wrench, Adjustable Wrench

1. Remove handle (A), trim cap (B), and bonnet nut (C).
2. Ensure seal is in place on bottom of new cartridge.
3. Install cartridge (D) with guide pins on bottom of cartridge aligned with pin openings in faucet body.
4. Install bonnet nut (C) using a wrench.
5. Install trim cap (B) and handle (A).

If leak persists/If faucet leaks from spout outlet: SHUT OFF WATER SUPPLIES. Replace valve cartridge (D). When reinstalling parts, make sure bonnet nut (C) is tightened securely with a wrench.

WARNING: Failure to securely tighten bonnet nut with a wrench could result in water damage.

Note: Do not attempt to disassemble cartridge (D). There are no repairable parts in side.

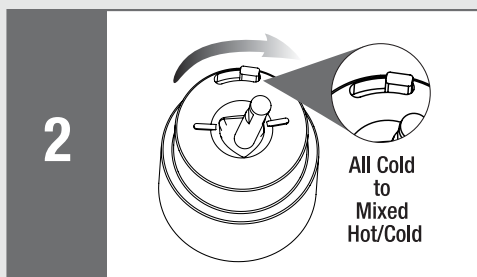
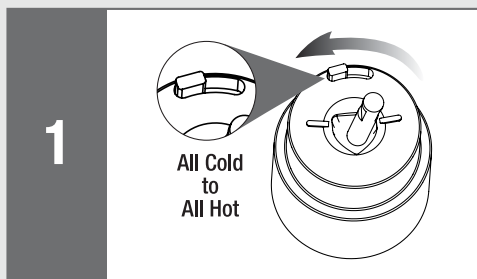
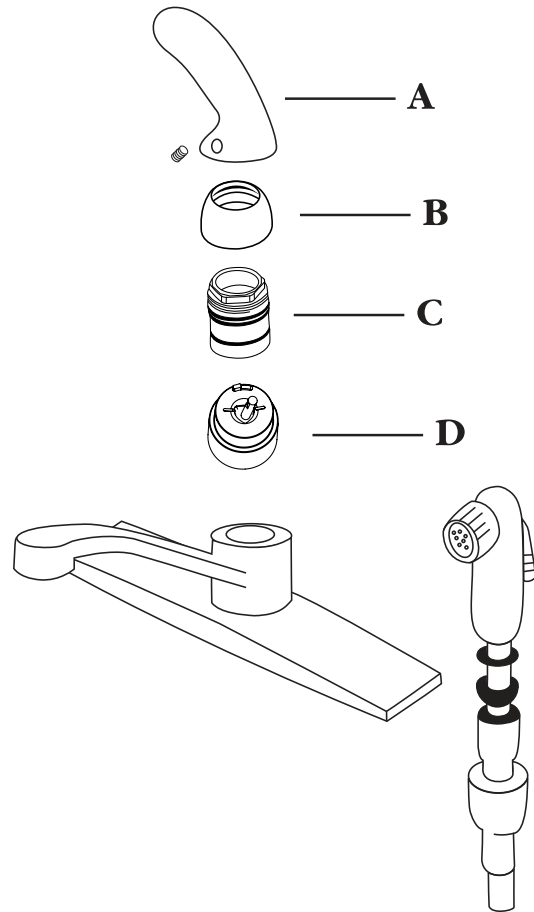

Setting The Handle Limit Stop (Optional)

This faucet has an handle limit stop that has two positions. Position 1, to the left, allows full handle motion (the full range is either “all cold” to “all hot”). Position 2, to the right, allows half of the normal handle motion (“all cold” to “mixed hot/cold”). The handle limit stop can be adjusted once the faucet is installed. Setting the handle limit stop in position 2 may help to prevent scalding because it limits the amount of hot water in the mix; however, this handle limit stop will not always prevent scalding because it does not make up for incoming pressure or sudden temperature changes. To change positions of the handle limit stop, first remove the handle; move the valve stem to the all cold position so the water is on; change the position of the handle limit stop; turn off the water; and reinstall the handle.